

PLUG P/N	CKT	DIM "A"	DIM "B"	DIM "C"	DIM "D"
2004882002	2	9.60	10.00	15.00	4.95
2004882003	3	13.80	14.20	19.20	4.95
2004882004	4	18.00	18.40	23.40	4.95
2004882005	5	22.20	22.60	27.60	12.95
2004882006	6	26.40	26.80	31.80	12.95

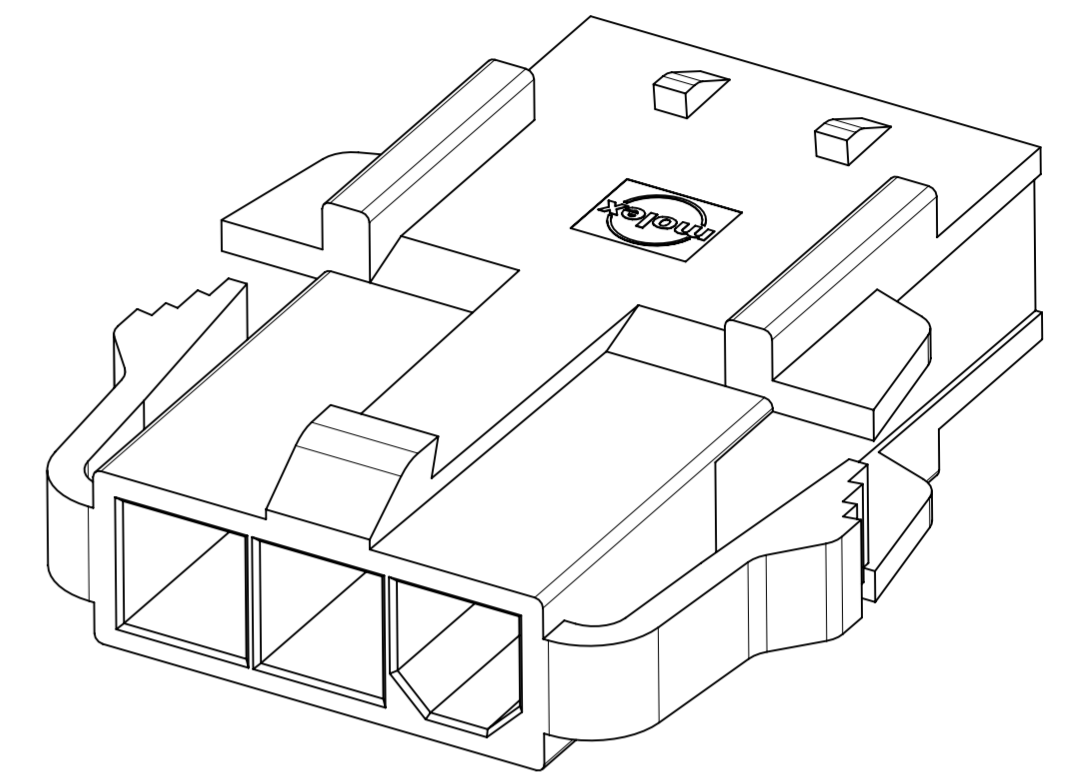

MOLEX LOGO DIM "D" REF

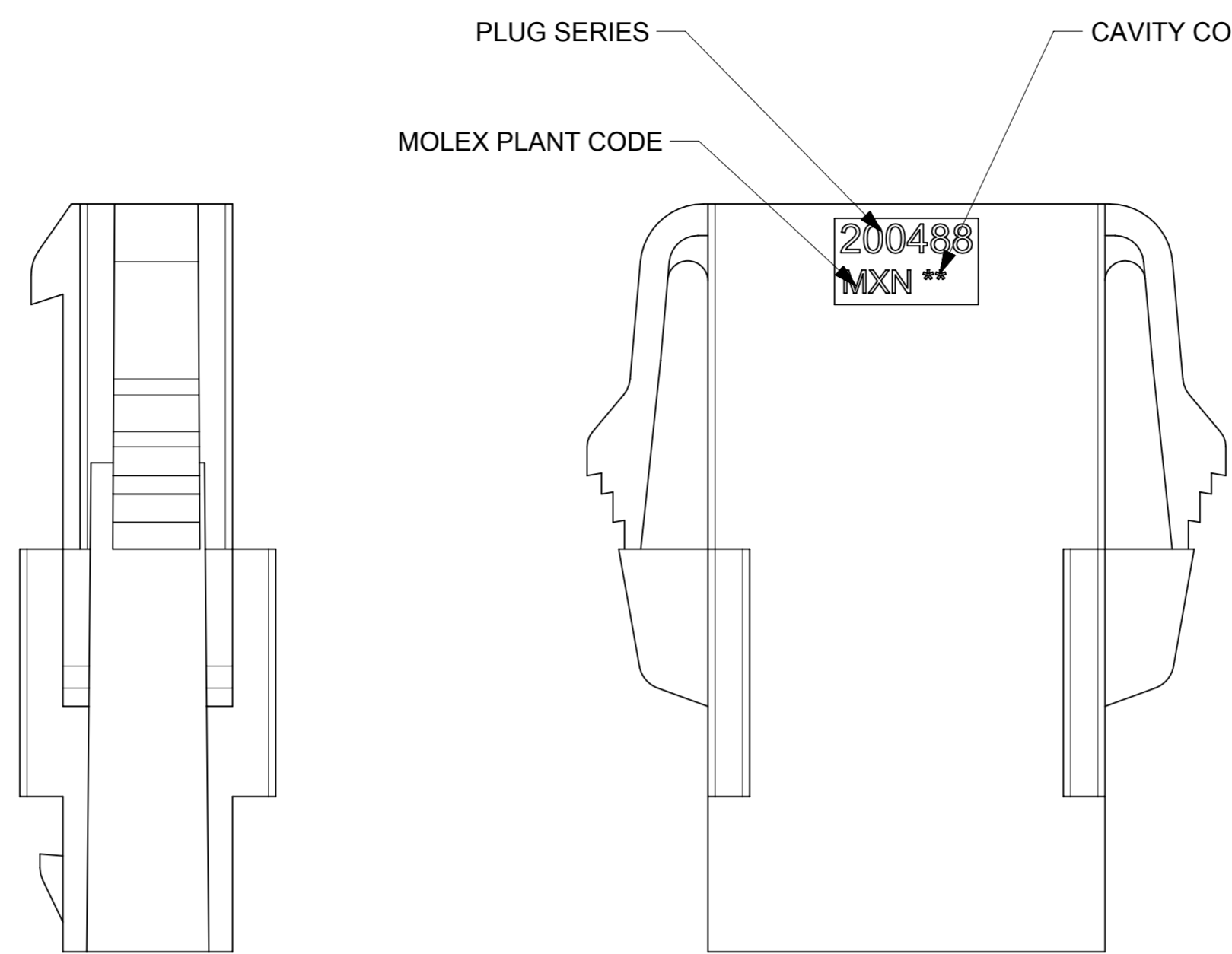
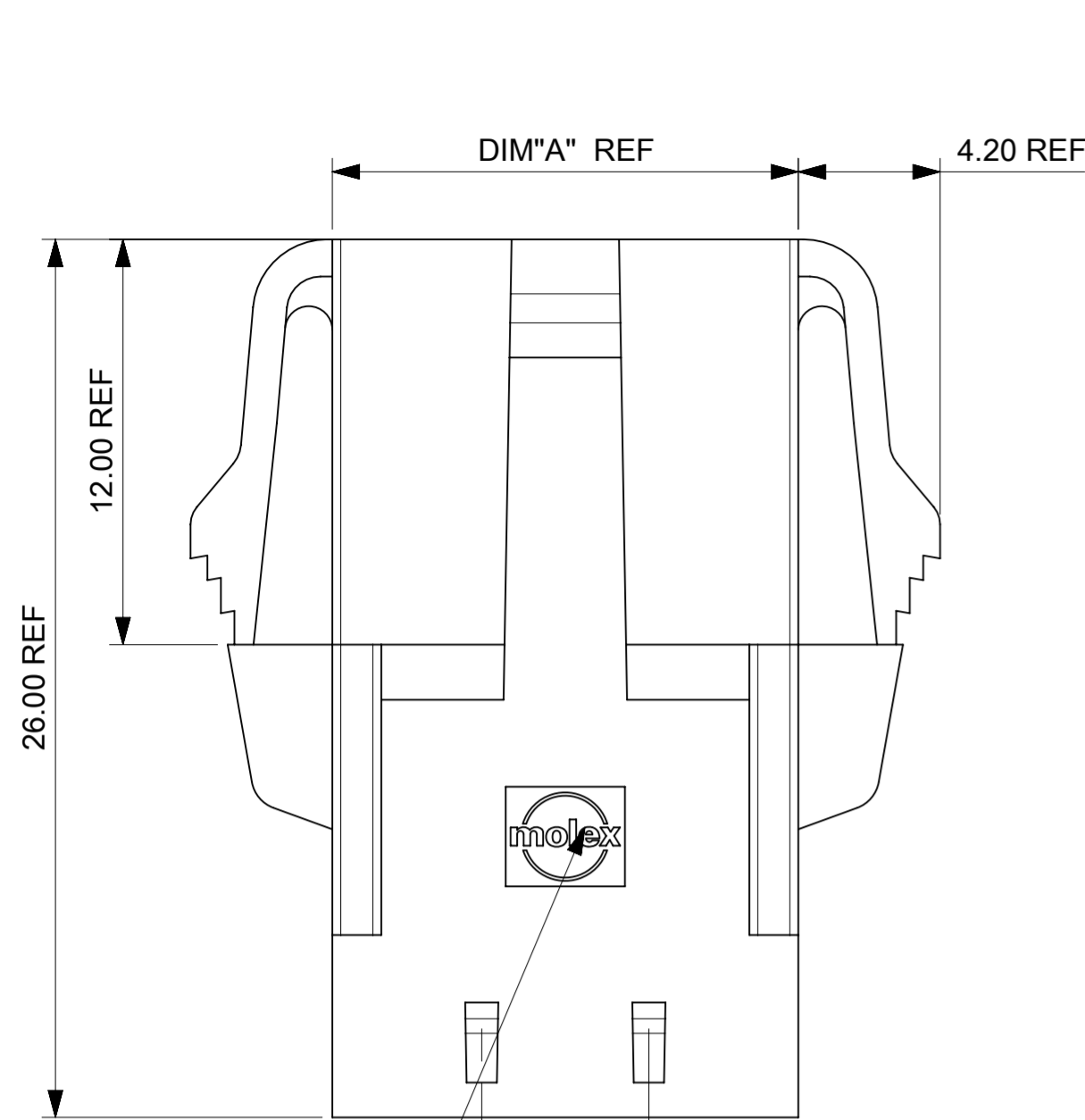
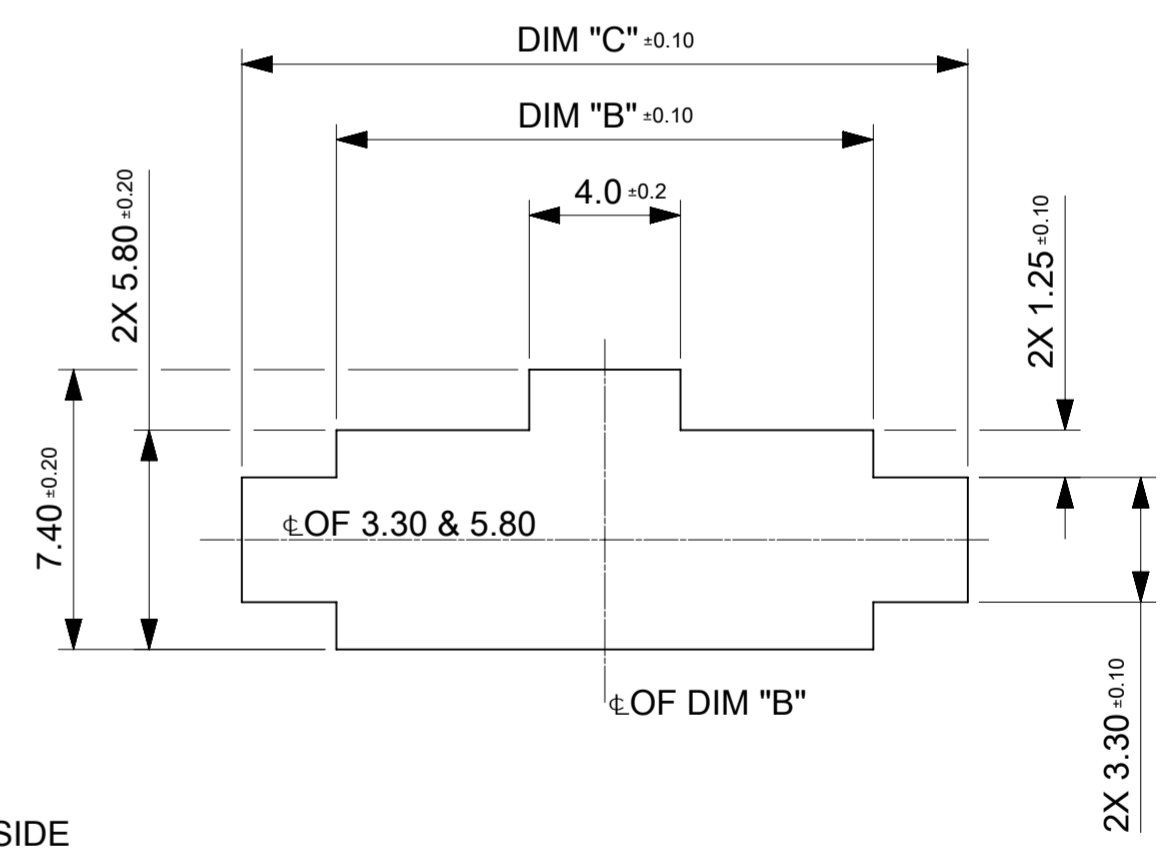
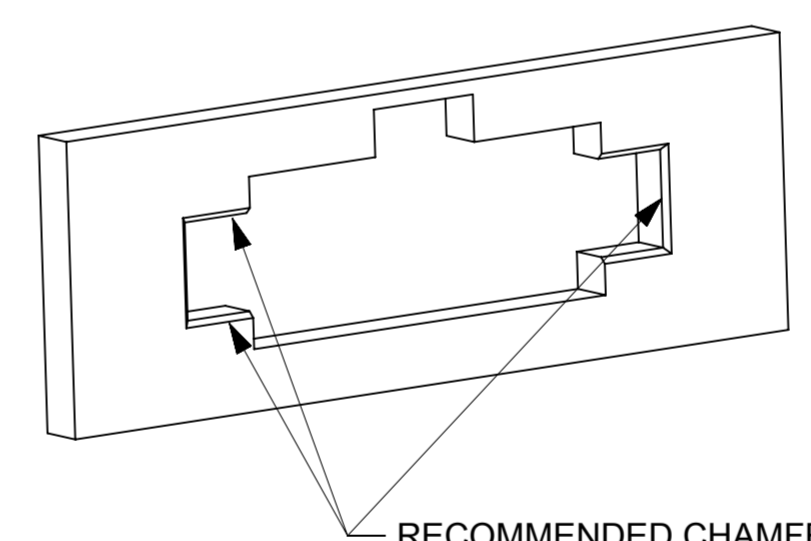
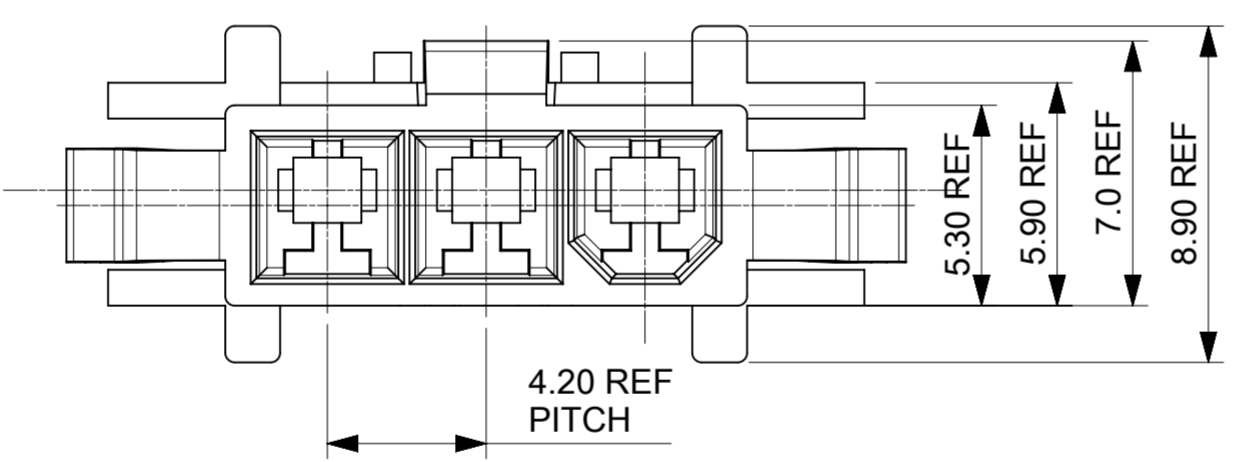
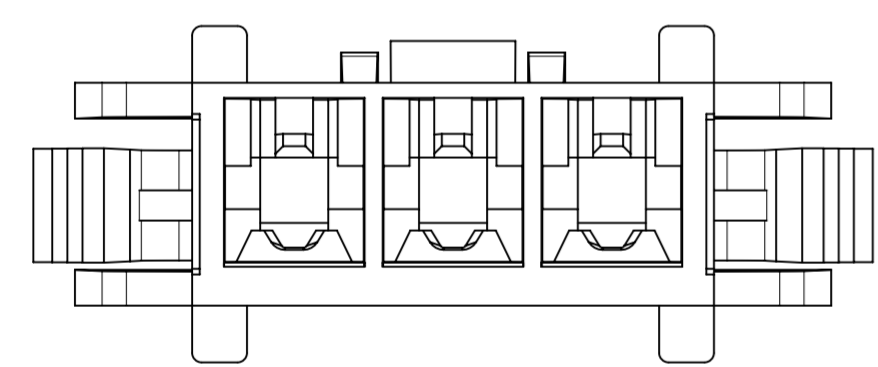

RECOMMENDED PANEL CUT-OUT DIMENSIONS  
PANEL THICKNESS 0.80-2.00MM

- NOTES:
- MATERIAL:  
NYLON, UL 94V-0 AND GLOW WIRE CAPABLE PER IEC60335-1; COLOR: BLACK
  - FINISH: NONE
  - PRODUCT SPECIFICATION: 2131370000-PS/2029880002-PS  
APPLICATION SPECIFICATION: 2131370000-AS
  - PACKAGING SPECIFICATION: 200488-0001-PK  
REFER TO AS-45499-001 FOR MOISTURIZING NYLON CONNECTOR PARTS.
  - THIS PART TO BE USED WITH FEMALE TERMINAL SERIES 172765, 203070 AND TPA SERIES 172709-2\*\*\*.
  - THIS PART MATES WITH RECEPTACLE SERIES 200453-1\*\*\*
  - THIS PART CONFORMS TO CLASS 'B' REQUIREMENTS OF COSMETIC SPECIFICATION PS-45499-002.
  - SEE DRAWING 1727090002-SD FOR OTHER TPA INFORMATION.
  - SEE DRAWING 2004531000(SD) FOR OTHER RECEPTACLE INFORMATION.
  - SEE DRAWINGS SD-172718-0000 AND 2029880001-PSD FOR OTHER CRIMP TERMINAL INFORMATION.

THIS DRAWING CONTAINS INFORMATION THAT IS PROPRIETARY TO MOLEX ELECTRONIC TECHNOLOGIES, LLC AND SHOULD NOT BE USED WITHOUT WRITTEN PERMISSION													
DIMENSION UNITS		SCALE		CURRENT REV DESC:									
mm		NTS											
GENERAL TOLERANCES (UNLESS SPECIFIED)				<p><b>molex</b></p> <p>SD-DRAWING OF MINI-FIT SIGMA SR PLUG</p> <p>PRODUCT CUSTOMER DRAWING</p>									
ANGULAR TOL		± °								EC NO: 787525		2024/05/28	
4 PLACES		±								DRWN: JERRYW8		2024/05/30	
3 PLACES		±								CHK'D: XQZHANG		2024/05/30	
2 PLACES		± 0.25								APPR: XQZHANG		2024/05/30	
1 PLACE		± 0.36		INITIAL REVISION:									
0 PLACES		±		DRWN: ALU002		2019/09/24							
				APPR: YXZHENG		2019/10/11							
DRAFT WHERE APPLICABLE MUST REMAIN WITHIN DIMENSIONS		THIRD ANGLE PROJECTION		DRAWING		SERIES		MATERIAL NUMBER					
				A2-SIZE		200488		SEE TABLE					
DOCUMENT STATUS		P1		RELEASE DATE		2024/05/30		09:41:54					
13		12		11		10		9					
8		7		6		5		4					
3		2		1									

DOCUMENT STATUS	P1	RELEASE DATE	2024/05/30	09:41:54
-----------------	----	--------------	------------	----------

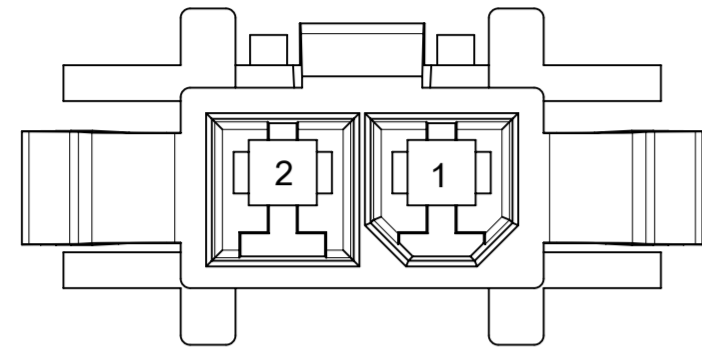

2-CKT

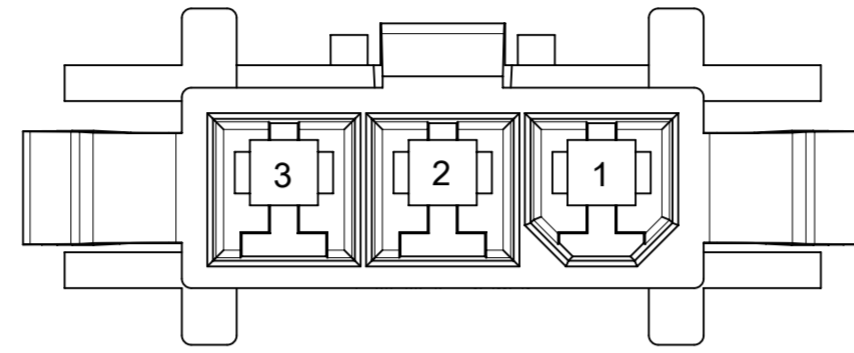

3-CKT

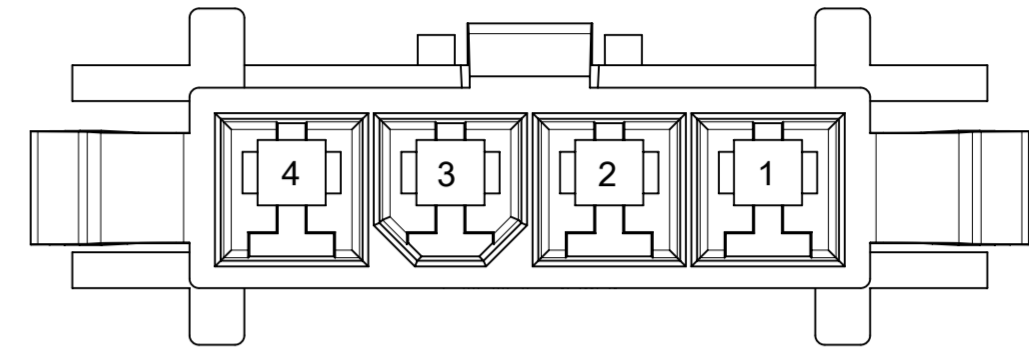

4-CKT

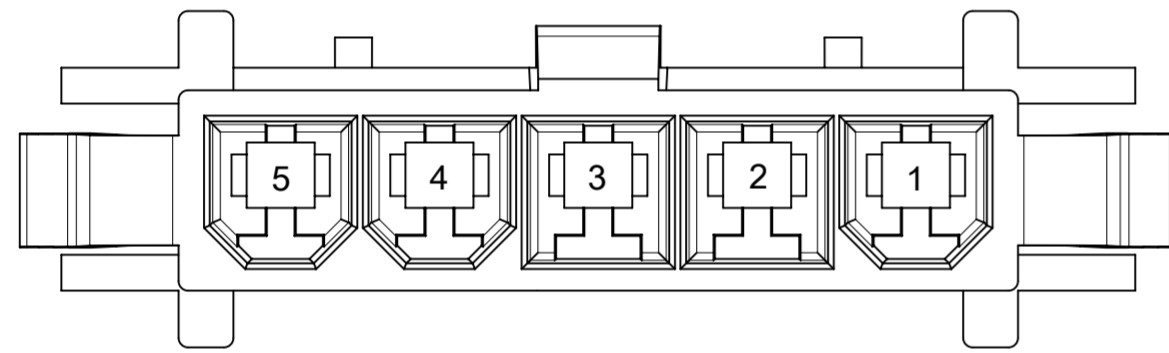

5-CKT

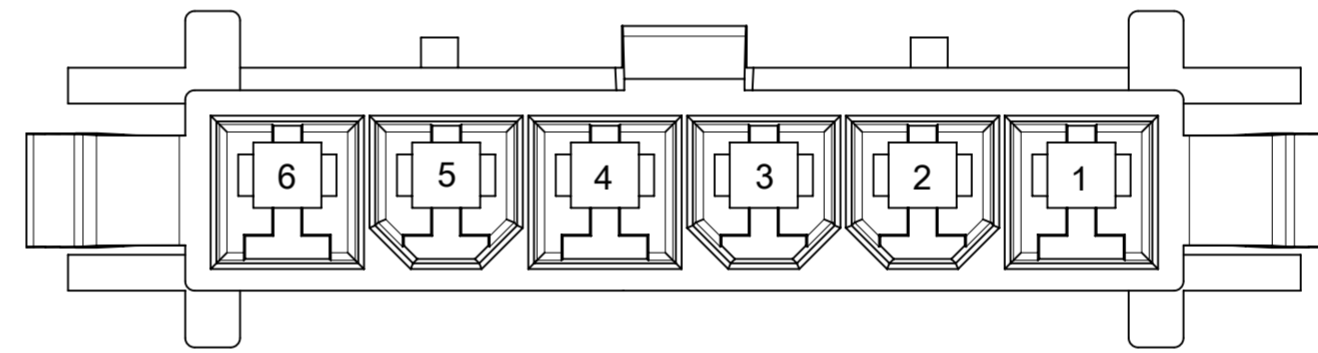

6-CKT

FUNCTIONAL SYMBOLS	THIS DRAWING CONTAINS INFORMATION THAT IS PROPRIETARY TO MOLEX ELECTRONIC TECHNOLOGIES, LLC AND SHOULD NOT BE USED WITHOUT WRITTEN PERMISSION									
	DIMENSION UNITS	SCALE	CURRENT REV DESC:							
$\frac{F}{A} = 0$	mm	NTS	EC NO: 787525 DRWN: JERRYW8 2024/05/28 CHK'D: XQZHANG 2024/05/30 APPR: XQZHANG 2024/05/30 INITIAL REVISION: DRWN: ALU002 2019/09/24 APPR: YXZHENG 2019/10/11							
$\frac{F}{C} = 0$	GENERAL TOLERANCES (UNLESS SPECIFIED)									
$\frac{F}{P} = 0$	ANGULAR TOL	± °								
DIVISIONAL SYMBOLS	4 PLACES	±								
	3 PLACES	±								
	2 PLACES	± 0.25								
	1 PLACE	± 0.36								
	0 PLACES	±								
	DRAFT WHERE APPLICABLE MUST REMAIN WITHIN DIMENSIONS	THIRD ANGLE PROJECTION	DRAWING	SERIES	MATERIAL NUMBER	CUSTOMER	SHEET NUMBER			
			A2-SIZE	200488	SEE TABLE	GENERAL MARKET	2 OF 2			

**molex**

SD-DRAWING OF MINI-FIT SIGMA SR PLUG

PRODUCT CUSTOMER DRAWING

DOCUMENT NUMBER	DOC TYPE	DOC PART	REVISION
2004880001-SD	PSD	000	B3

DOCUMENT STATUS	P1	RELEASE DATE	2024/05/30	09:41:54
-----------------	----	--------------	------------	----------