

MOLEX OFFERS THE MOST ADVANCED CUSTOMER ELECTRONIC SKIN PATCH TECHNOLOGY, WITH SUPERIOR ELECTRONIC COMPONENT INTEGRATION

FLEXIBLE PRINTED CIRCUIT SOLUTIONS

providing the creativity, functionality and reliability needed to meet medical device design requirements



ADHESIVES

that are biocompatible and ensure sensors stay affixed



SENSOR AND COMPONENT INTEGRATION

for optimal form factor, performance, manufacturability and cost

MOLDING, ASSEMBLY, AND FINAL PACKAGING

providing advanced injection molding technologies and assembly



PRINTED CIRCUIT SOLUTIONS

ENHANCED FORM, FIT AND FUNCTION

SOLVING PROBLEMS FOR DESIGN AND MANUFACTURING

MOLEX DESIGN AND ENGINEERING

OUR CUSTOMER ENGAGEMENT MODEL PROVIDING RELIABLE DESIGN AND ENGINEERING EXPERTISE



GLOBAL SUPPORT

Design and manufacture in Europe, Asia and North America



COLLABORATIVE DESIGN

Work side-by-side with our customers



TRUSTED MANUFACTURER

Dedicated, cross-functional team with customer-first mentality



PROVEN HISTORY

More than 75 years of innovation

YOUR FLEXIBLE CIRCUIT SOLUTIONS PROVIDER FOR WEARABLE MEDICAL DEVICES

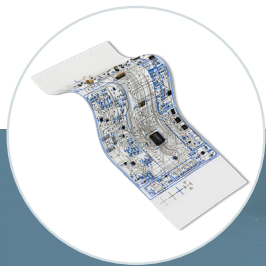

FLEXIBLE PRINTED CIRCUIT SOLUTIONS

- Customized flexible hybrid electronics (FHE) utilizing printed electronic (PE) inks and substrates
- Customizable circuitry ideal for the creative, functional and reliability needs of wearable medical device design

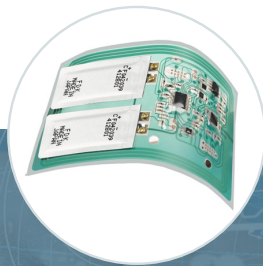

SENSOR AND COMPONENT INTEGRATION

- Sensor and component solutions to optimize form factor, performance, manufacturability and cost:
 - Wireless connectivity
 - Biosensors
 - Power sources

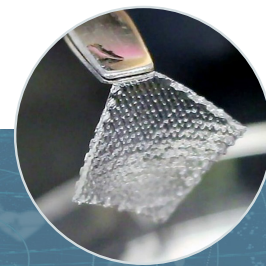

ADHESIVES AND CONVERTING

- Ensuring both reliable sensor/device performance and patient comfort
- Adhesives proven for biocompatibility and resistance to moisture, salt and cellturnover
- Complete converting solutions for applying adhesive onto substrate/device

SENSOR AND COMPONENT INTEGRATION

Our surface-mount technology integrates a variety of components and sensors into one compact, easy-to-use, wireless device.

1. BLE connectivity to mobile app
2. On/off dome switch
3. Printed antenna
4. Thin-flex battery for one-time use
5. Flexible substrate
6. Hydrogel and electrodes
7. Adhesive layer and release liner

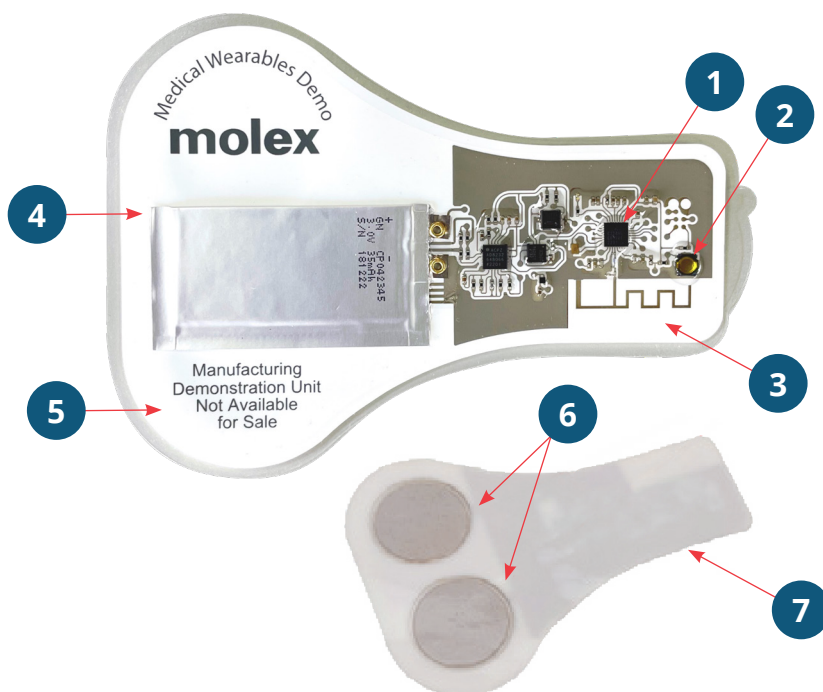

987652-5632